

\$532,000 - 3238 Magpie Link, Edmonton

MLS® #E4422079

\$532,000

4 Bedroom, 3.00 Bathroom, 1,750 sqft
Single Family on 0.00 Acres

Starling, Edmonton, AB

Ready-Move-In! Stunning 1750 sq. ft. single-family detached home in Starling South, Edmonton! This beautifully designed property is built on a corner lot and features a main floor with a full bath, bedroom/den, spacious living room, dining area, and modern kitchen. Upstairs, find a bonus room, 3 bedrooms and 2 full bathrooms, including a luxurious primary suite. private side entrance for potential legal basement suite. Open to above foyer at entrance. The home comes with appliances credit, and garage pad. Quick possession

Built in 2025

Essential Information

MLS® #	E4422079
Price	\$532,000
Bedrooms	4
Bathrooms	3.00
Full Baths	3
Square Footage	1,750
Acres	0.00
Year Built	2025
Type	Single Family
Sub-Type	Detached Single Family
Style	2 Storey
Status	Active

Community Information



FRONT ELEVATION

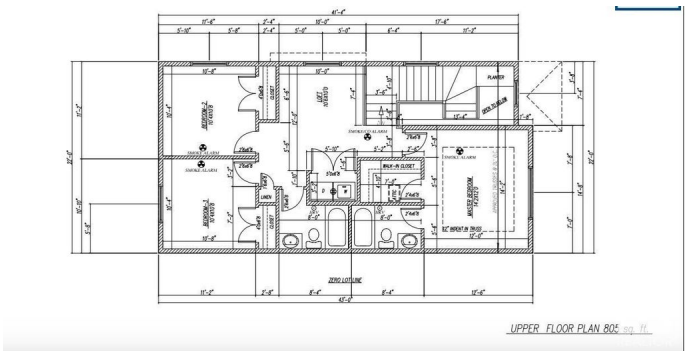
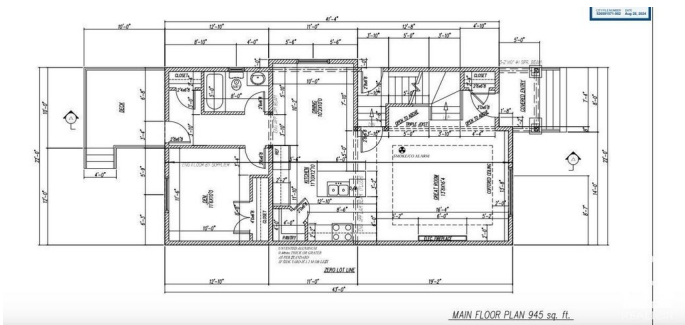

Address	3238 Magpie Link
Area	Edmonton
Subdivision	Starling
City	Edmonton
County	ALBERTA
Province	AB
Postal Code	T5S 0V4

Amenities

Amenities	Ceiling 9 ft., Exterior Walls- 2"x6", 9 ft. Basement Ceiling
Parking Spaces	2
Parking	Parking Pad Cement/Paved

Interior

Interior Features	ensuite bathroom
Appliances	Builder Appliance Credit
Heating	Forced Air-1, Natural Gas
Fireplace	Yes
Fireplaces	Heatilator/Fan
Stories	2
Has Basement	Yes
Basement	Full, Unfinished

Exterior

Exterior	Wood, Vinyl
Exterior Features	Back Lane, Golf Nearby, Playground Nearby, Ravine View
Roof	Asphalt Shingles
Construction	Wood, Vinyl
Foundation	Concrete Perimeter

Additional Information

Date Listed	February 19th, 2025
Days on Market	73
Zoning	Zone 59
HOA Fees	100
HOA Fees Freq.	Annually

DATA IS DEEMED RELIABLE BUT IS NOT GUARANTEED ACCURATE BY THE REALTORS® ASSOCIATION OF EDMONTON. COPYRIGHT 2025 BY THE REALTORS® ASSOCIATION OF EDMONTON. ALL RIGHTS RESERVED. Trademarks are owned or controlled by the Canadian Real Estate Association (CREA) and identify real estate professionals who are members of CREA (REALTOR®, REALTORS®) and/or the quality of services they

provide (MLS® , Multiple Listing Service®)
Listing information last updated on May 3rd, 2025 at 8:32pm MDT